



# ZEON XC/XD/XP Winch Operation Quick Start Guide



ALWAYS Read All Product Literature **BEFORE** installing product.  
For complete winch operation and techniques read the Basic Guide to Winching Techniques found online at:



Lire toute la documentation produit **AVANT** d'installer le produit.

Pour le fonctionnement et les techniques complètes du treuil, lisez le Guide de base des techniques de treuillage disponible en ligne à :

Leer toda la documentación del producto **ANTES** de instalar el producto.

Para conocer las técnicas y el funcionamiento completo del cabrestante, lea la Guía básica de técnicas de cabrestante que se encuentra en línea en:



<https://qrco.de/product-literature>

## THE BASICS / NOTIONS DE BASE / LO ESENCIAL

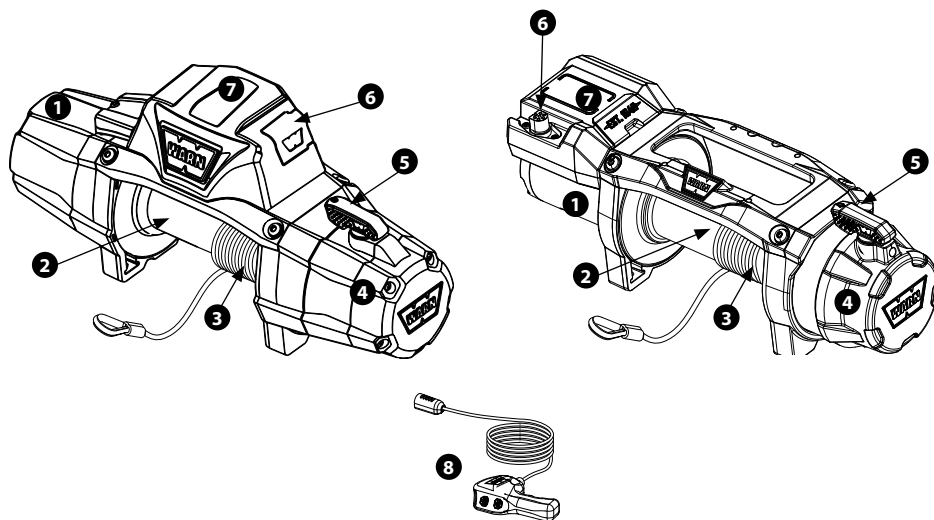

1	MOTOR	5	CLUTCH LEVER	1	MOTEUR	5	LEVIER D'EMBRAYAGE
2	WINCH DRUM	6	REMOTE SOCKET	2	TAMBOUR DU TREUIL	6	PRISE DE TÉLÉCOMMANDE
3	WINCH ROPE	7	CONTROL PACK	3	CÂBLE DU TREUIL	7	COFFRET DE COMMANDE
4	GEARTRAIN	8	REMOTE CONTROL	4	TRAIN D'ENGRENAGES	8	TÉLÉCOMMANDE

1	MOTOR	5	PALANCA DE EMBRAYAGE
2	TAMBOR DEL CABRESTANTE	6	CASQUILLO DEL CONTROL REMOTO
3	CABLE DEL CABRESTANTE	7	PAQUETE DE CONTROL
4	TREN DE ENGRANAJES	8	CONTROL REMOTO

### Remote Control Operation/ Télécommande/ Control Remoto

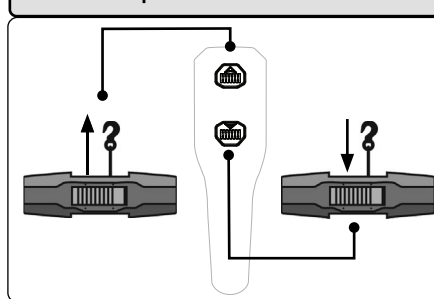

### Clutch Lever Operation/ Fonctionnement de l'embrayage/ Accionamiento del embrague

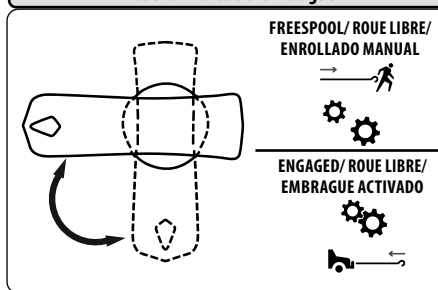

## SYSTEM CHECK / VÉRIFICATION DU SYSTÈME / COMPROBACIÓN DEL SISTEMA

**⚠ WARNING** Always connect red (+) power cable **ONLY** to the positive (+) terminal of the battery.

**⚠ WARNING** Always connect black ground (-) power cable **ONLY** to the negative (-) terminal of the battery.

**⚠ AVERTISSEMENT** Connectez toujours rouge (+) câble d'alimentation **UNIQUEMENT** à la borne positive (+) la borne de la batterie.

**⚠ AVERTISSEMENT** Connectez toujours le câble d'alimentation noir (-) **UNIQUEMENT** à la borne négative (-) de la batterie.

**⚠ ATENCIÓN** Conecte siempre rojo (+) el cable de alimentación solamente a la positiva (+) el terminal de la batería.

**⚠ ATENCIÓN** Conecte siempre tierra negro (-) el cable de alimentación sólo al terminal negativo (-) de la batería.

### Perform system check/Vérification du système/ Revisión del sistema :

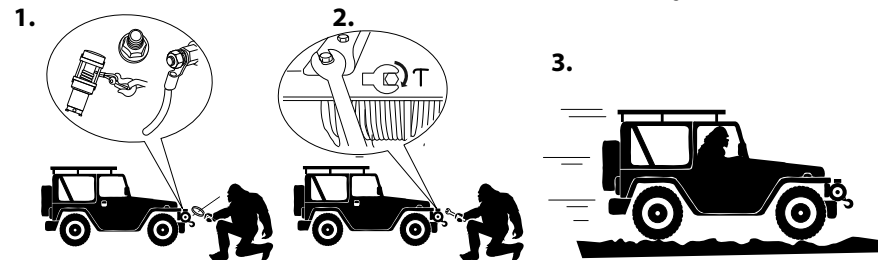

## STRETCHING WINCH ROPE/ ÉTIREMENT DU CÂBLE DU TREUIL/ ESTIRAMIENTO DEL CABLE DEL CABRESTANTE

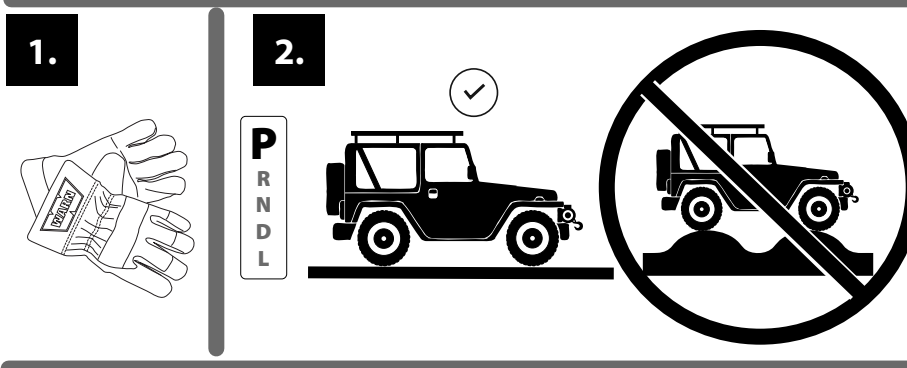

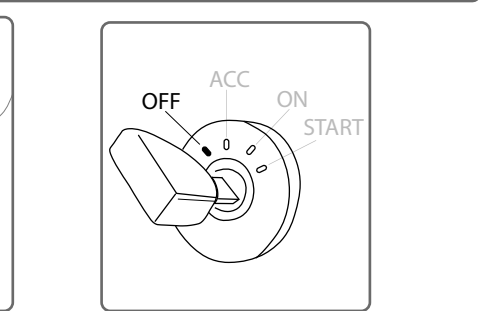
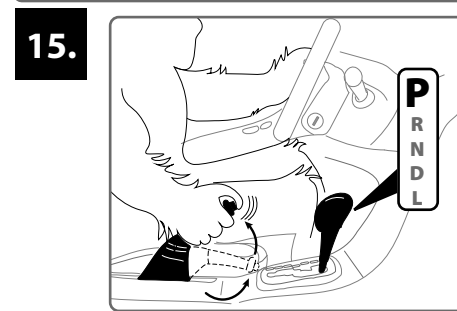
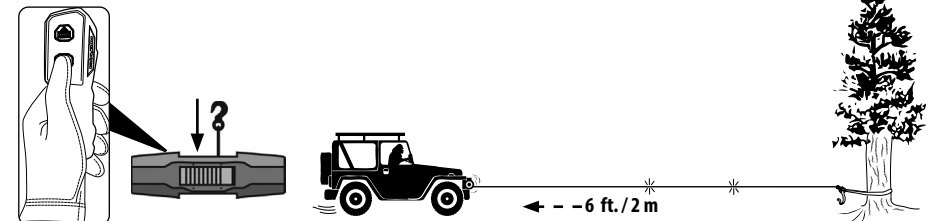
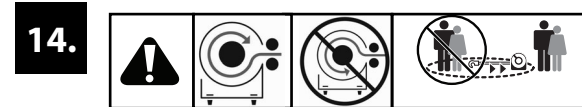
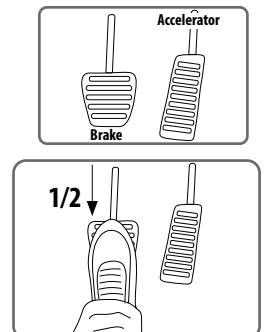
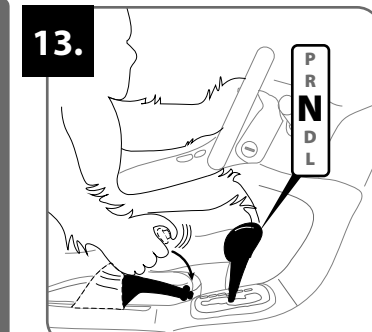
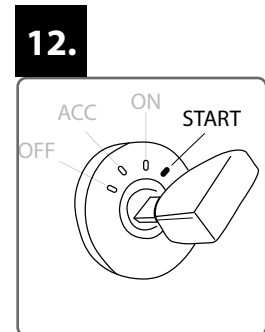
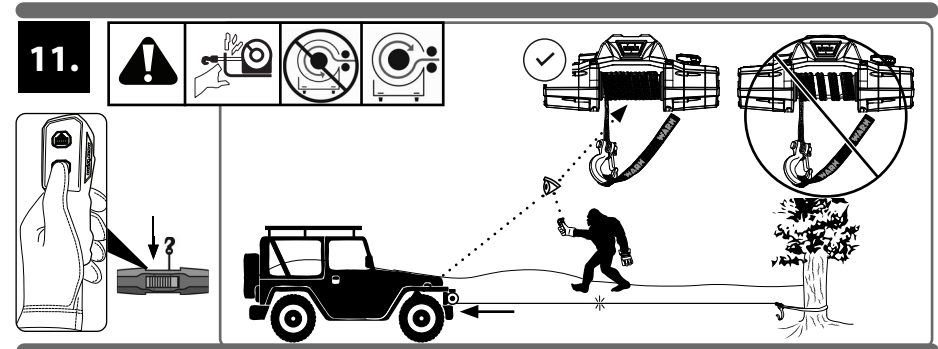
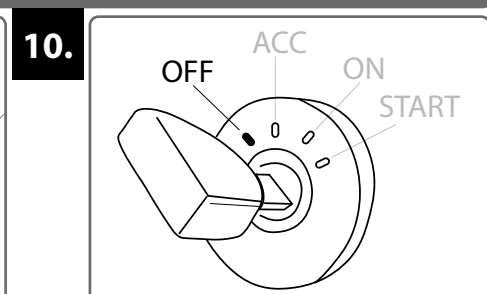
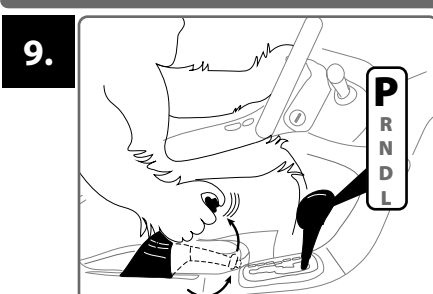
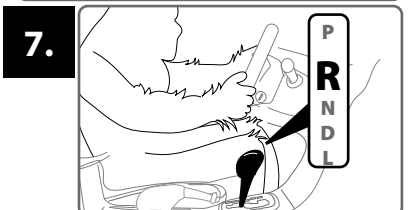
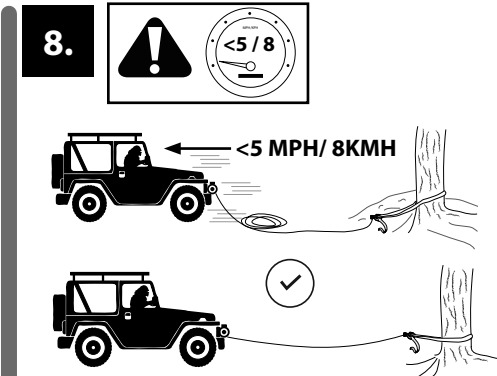
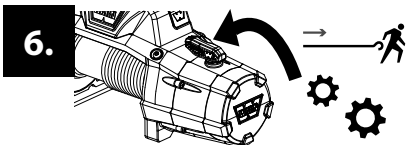
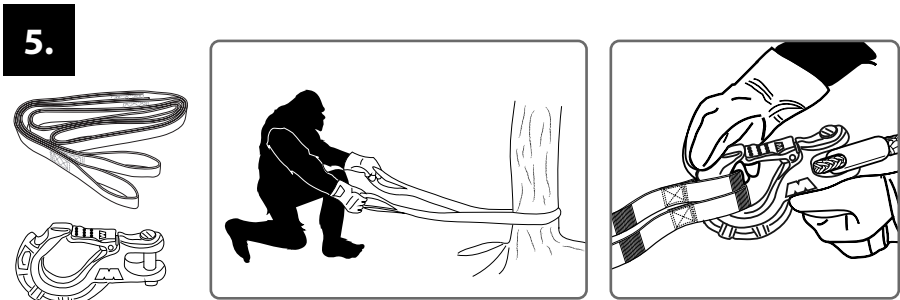
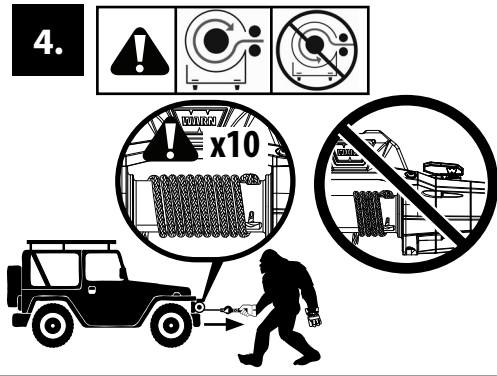
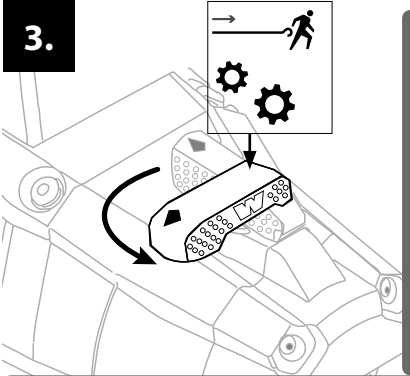

16.

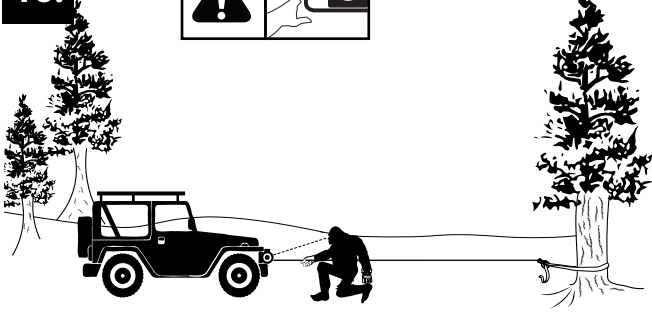
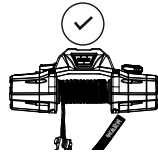
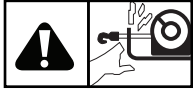

17.

18.

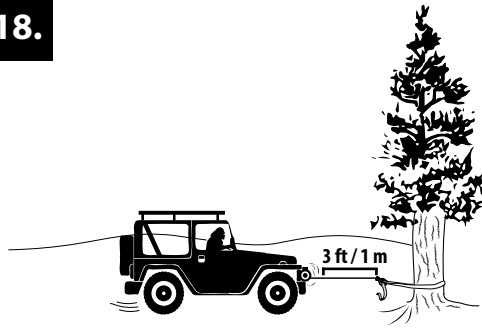
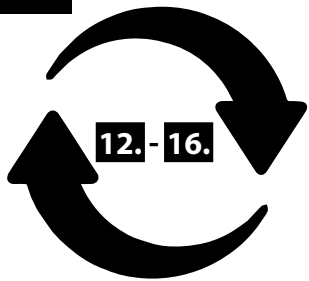

19.

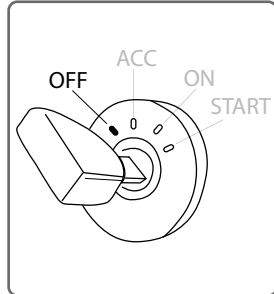
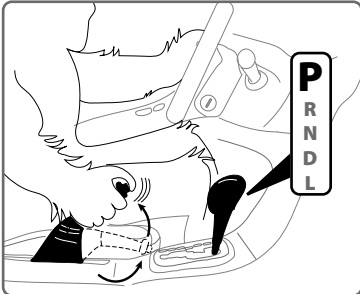

20.

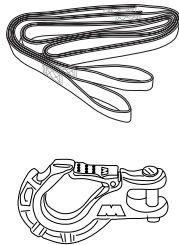
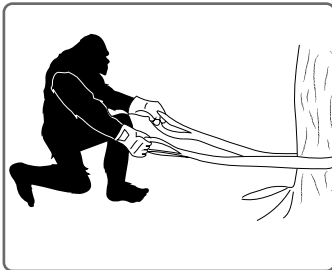
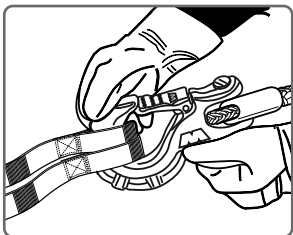

21.

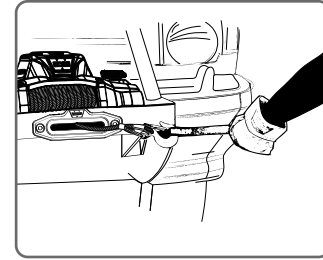
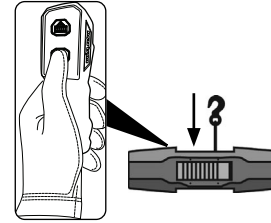

<https://qrco.de/product-literature>

**For full Winch Techniques and Video Resources visit:**  
**Pour consulter l'intégralité des techniques de treuil et des ressources vidéo:**  
**Para conocer todas las técnicas de cabrestante y recursos en video, visite:**  
**<https://www.warn.com/basic-guide-to-winchng-intro>**



**Kurzanleitung zur Bedienung der Winde/ Vinschrift  
Snabbstartguide/ Guida rapida all'uso del verricello/ Vinsinn  
käytön pikaopas/ Snelle startgids voor lierbediening/ Guia de  
início rápido para operação de guincho**



- **BEVOR** Sie das Produkt installieren, lesen Sie bitte die gesamte dazugehörige Literatur :
- Läs all produktdokumentation **INNAN** du installerar produkten:
- Leggere sempre la documentazione per intero **PRIMA** di installare il prodotto:
- Sempre leia todos os materiais de consulta **ANTES** de instalar o produto:
- Lue kaikki tuotteen oppaat **ENNEN** tuotteen asennusta:
- Lees altijd alle productdocumentatie **VOORDAT** u het product installeert:



[https://qrco.de/  
product-literature](https://qrco.de/product-literature)

**GRUNDLAGEN/ GRUNDERNA/ NOZIONI DI BASE/ BASISPRINCIPES/ NOÇÕES BÁSICAS/ PERUSIASIAT**

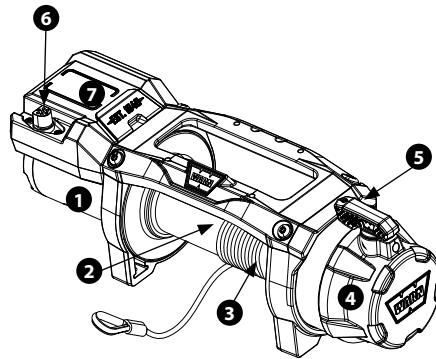
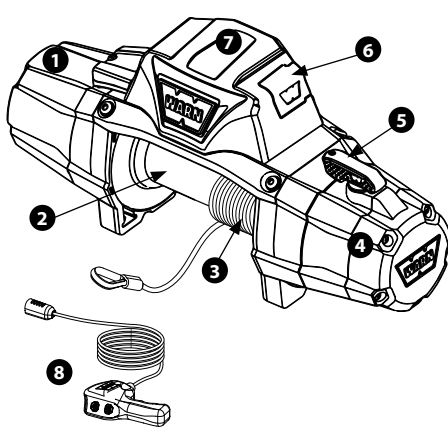

1	Moter	5	Kupplungshebel
2	Windentrommel	6	Anschluss Fernbedienung
3	Seil	7	Steuerung
4	Antriebsstrang	8	Die Fernbedienung

1	Moottori	5	Kytkinvipu
2	Vinssirumpu	6	Kauko-ohjaimen pistoke
3	Vinssivajeri	7	Ohjainyksikkö
4	Hamaspyörästö	8	Kauko-ohjain

1	Motor	5	Koppelingshendel
2	Liertrommel	6	Aansluiting afstandsbediening
3	Staalkabel	7	Bedieningskast
4	Tarttuminen	8	Afstandsbediening

1	Motore	5	Leva della frizione
2	Tamburo del verricello	6	Presa del comando a distanza
3	Fune del verricello	7	Gruppo di comando
4	Ingranaggio	8	Comando a distanza

1	Elmotor	5	Kopplingsspak
2	Vinschtrumma	6	Fjärrutttag
3	Vinschvajer	7	Reglerenhet
4	Transmission	8	Fjärrkontroll

1	Motor	5	Alavanca da embreagem
2	Tambor do guincho	6	Soquete remoto
3	Cabo de aço	7	Caixa de controle
4	Trem de engrenagens	8	Controle remoto

**Die Fernbedienung / Fjärrkontroll / Comando a distanza /  
Kauko-ohjain / Afstandsbediening / Controle remoto**

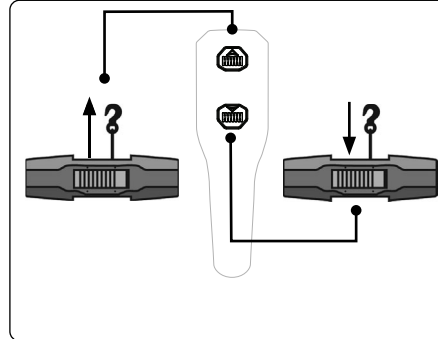

**Kupplungshebel / Kopplingsspak / Leva della frizione /  
Kytkinvipu / Koppelingshendel / Alavanca da embreagem**

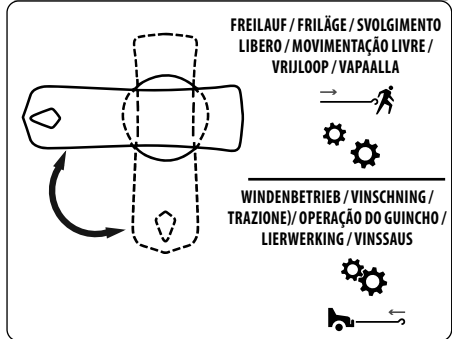

**SYSTEMPRÜFUNG / SYSTEMKONTROLL / CONTROLLO DEL SISTEMA / JÄRJESTELMÄN TARKASTUS / SYS-  
TEEMCONTROLE / VERIFICAÇÃO DO SISTEMA**

**⚠ ACHTUNG**  
Schließen Sie immer rot (+) Power Kabel nur an die Plusklemme (+) Pol der Batterie.

**⚠ ACHTUNG**  
Schließen Sie immer schwarz Masse (-) Netzkabel nur an die negative Klemme (-) der Batterie.

**⚠ FARA**  
Anslut alltid rött (+) ström kabel till BARA den positiva (+) polen på batteriet.

**⚠ FARA**  
Anslut alltid svart jord (-) kabel endast till den negativa (-) polen på batteriet.

**⚠ AVVERTENZA**  
Collegare sempre il cavo rosso (+) potere solo al polo positivo della batteria (+).

**⚠ AVVERTENZA**  
Collegare sempre fondo nero (-) il cavo di alimentazione SOLO per il polo negativo (-) della batteria.

**⚠ VAROITUS**  
Kytke aina punainen (+) tehonsyöttökaapeli VAIN positiiviseen (+) akun plusnavasta.

**⚠ VAROITUS**  
Liitä aina musta maahan (-) tehonsyöttökaapeli ainoastaan negatiivinen mittajohdo (-) akun.

**⚠ WAARSCHUWING**  
Sluit altijd de rode (+) power kabel ALLEEN op de positieve (+) pool van de accu.

**⚠ WAARSCHUWING**  
Sluit altijd zwarte massa (-) kabel alleen aan op de negatieve (-) pool van de accu.

**⚠ ADVERTÊNCIA**  
Sempre ligue o vermelho (+) cabo de alimentação apenas para a positiva (+) o terminal da bateria.

**⚠ ADVERTÊNCIA**  
Ligue sempre terra preta (-) cabo de alimentação apenas para o terminal negativo (-) da bateria.

**Systemprüfung / Systemkontroll / Controllo del sistema / Järjestelmän tarkastus /  
Systemcontrole / Verificação do sistema**

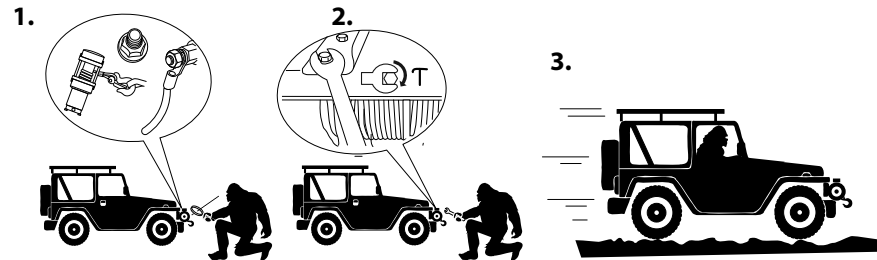

**STRETCH-WINDENSEIL/ STRETCH VINSCHREP/ CAVO ELASTICO PER ARGANO/ REK LIERTOUW/ CABO DE GUINCHO ESTICADO/ JOUSTAVA VINTSUN KOYSI**

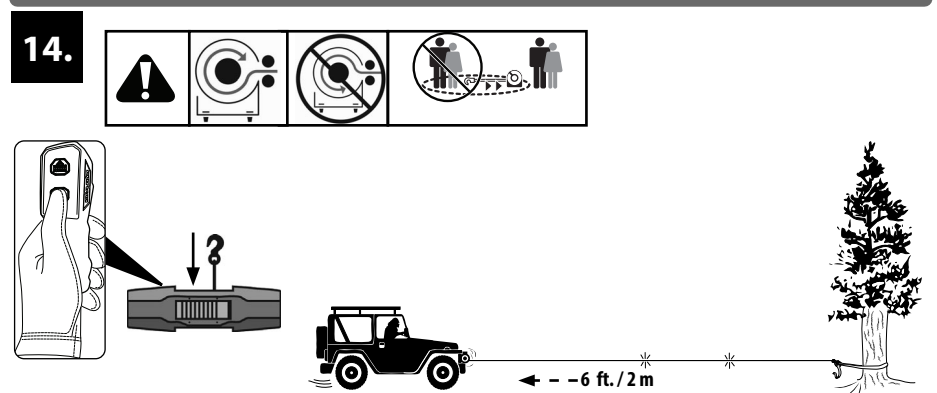
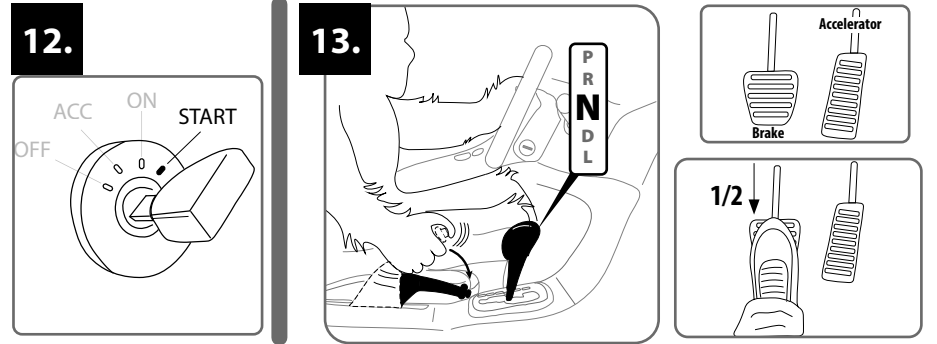
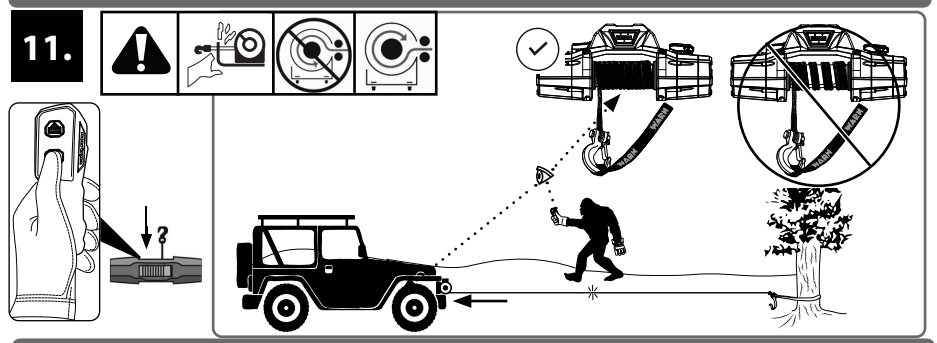
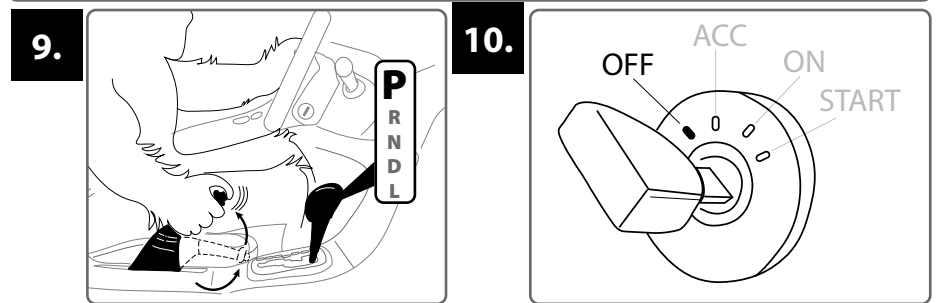
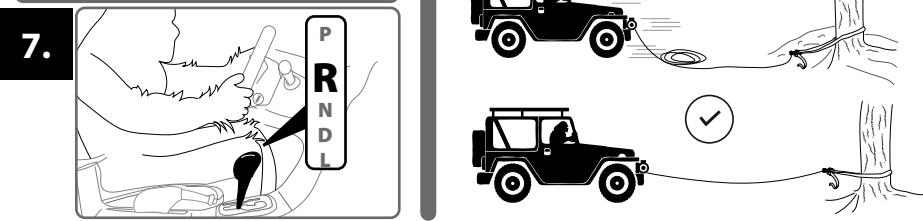
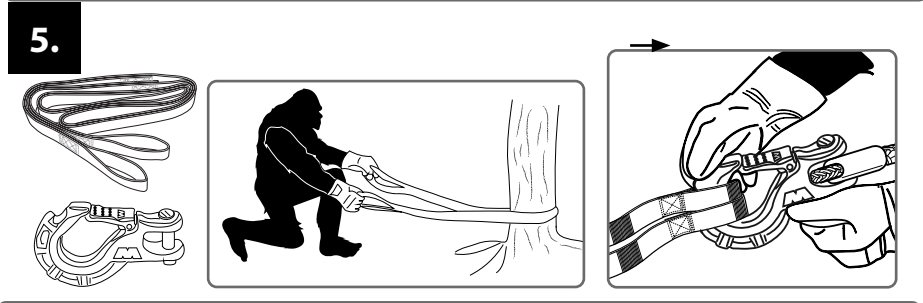
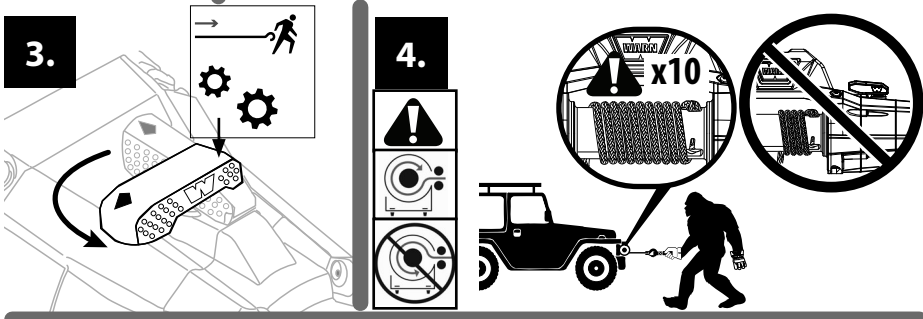
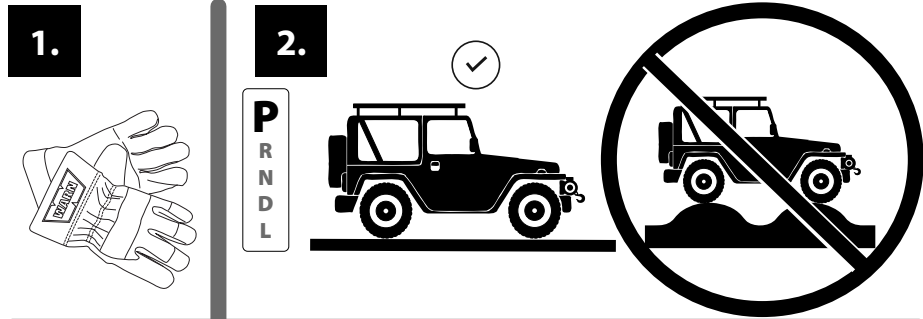

15.

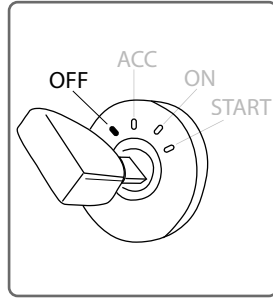
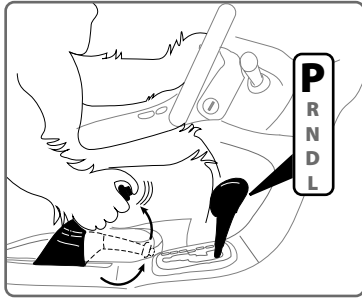

16.

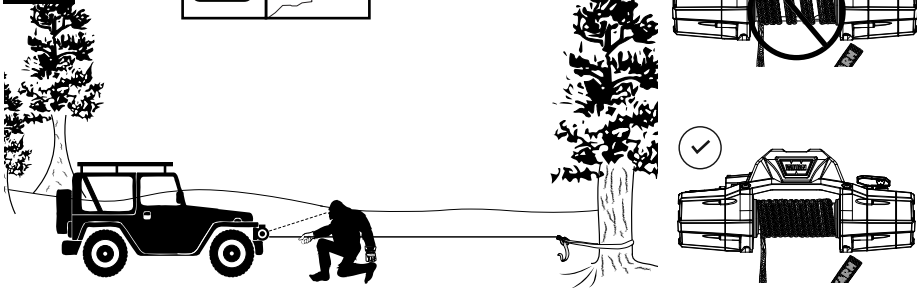
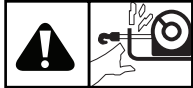

17.

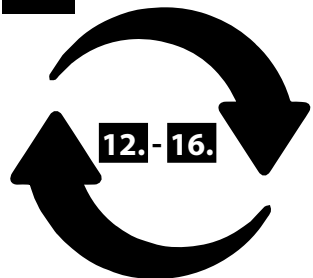

18.

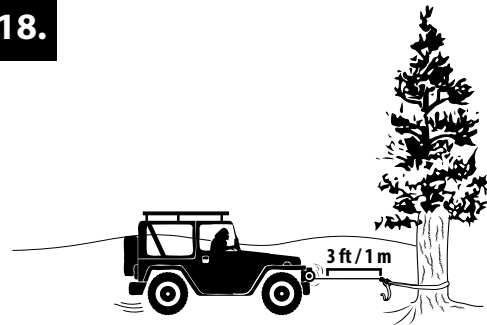

19.

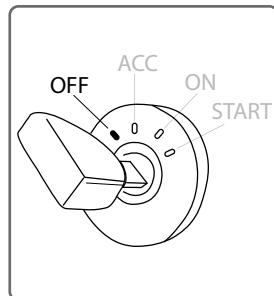
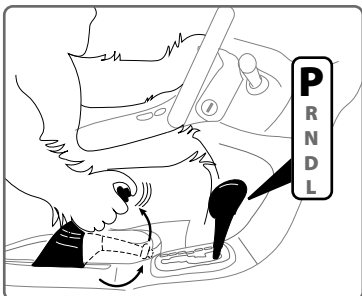

20.

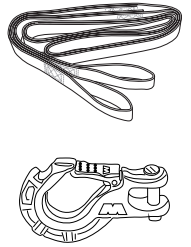
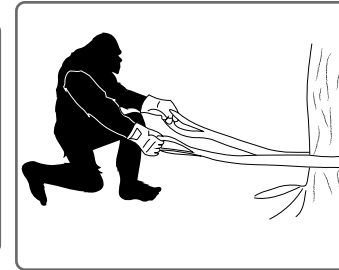
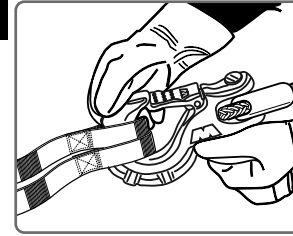

21.

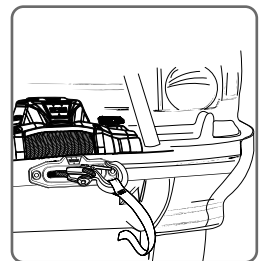
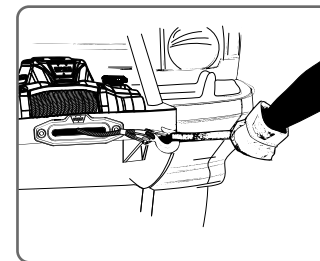
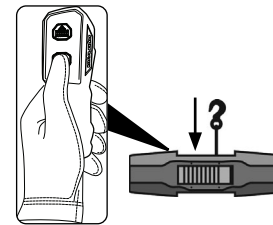
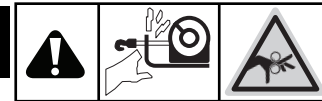

<https://qrco.de/product-literature>

Umfassende Informationen zu Windentechniken und Videoressourcen finden Sie unter:

För fullständiga vinschtekniker och videoresurser besök:

Per tecniche complete sul verricello e risorse video visita:

Bezoek voor volledige liertekniken en videobronnen:

Para técnicas completas de guincho e recursos de vídeo, visite:

Täydelliset vinnsiteknikat ja videoresurssit ovat osoitteessa:

<https://www.warn.com/basic-guide-to-winning-intro>