



INSTALLATION INSTRUCTIONS
ATV Winch Mounting Kit
Part Number: 68852
Applications: 2000+ Honda Rancher

As you read these instructions, you will see **NOTES**, **CAUTIONS**, and **WARNINGS**. Each message has a specific purpose. **NOTES** are additional information to help you complete a procedure. **CAUTIONS** are safety messages that indicate a potentially hazardous situation which, if not avoided, may result in minor or moderate injury. A **CAUTION** may also be used to alert against unsafe practice or possible equipment damage. **WARNINGS** are safety messages that indicate a potentially hazardous situation, which, if not avoided could result in serious injury. **CAUTIONS** and **WARNINGS** identify the hazard, indicate how to avoid the hazard, and advise of the probable consequence of not avoiding the hazard. **PLEASE WORK SAFELY!**

Before You Begin

This kit is compatible with WARN's line of ATV winches. Winch sold separately. Please read WARN's Winching Technique guide provided with the winch prior to use of this product.

Table of Contents

I.	Parts List	2
II.	Tools Required	2
III.	Ranger Installation	3
V.	Maintenance/Care	10

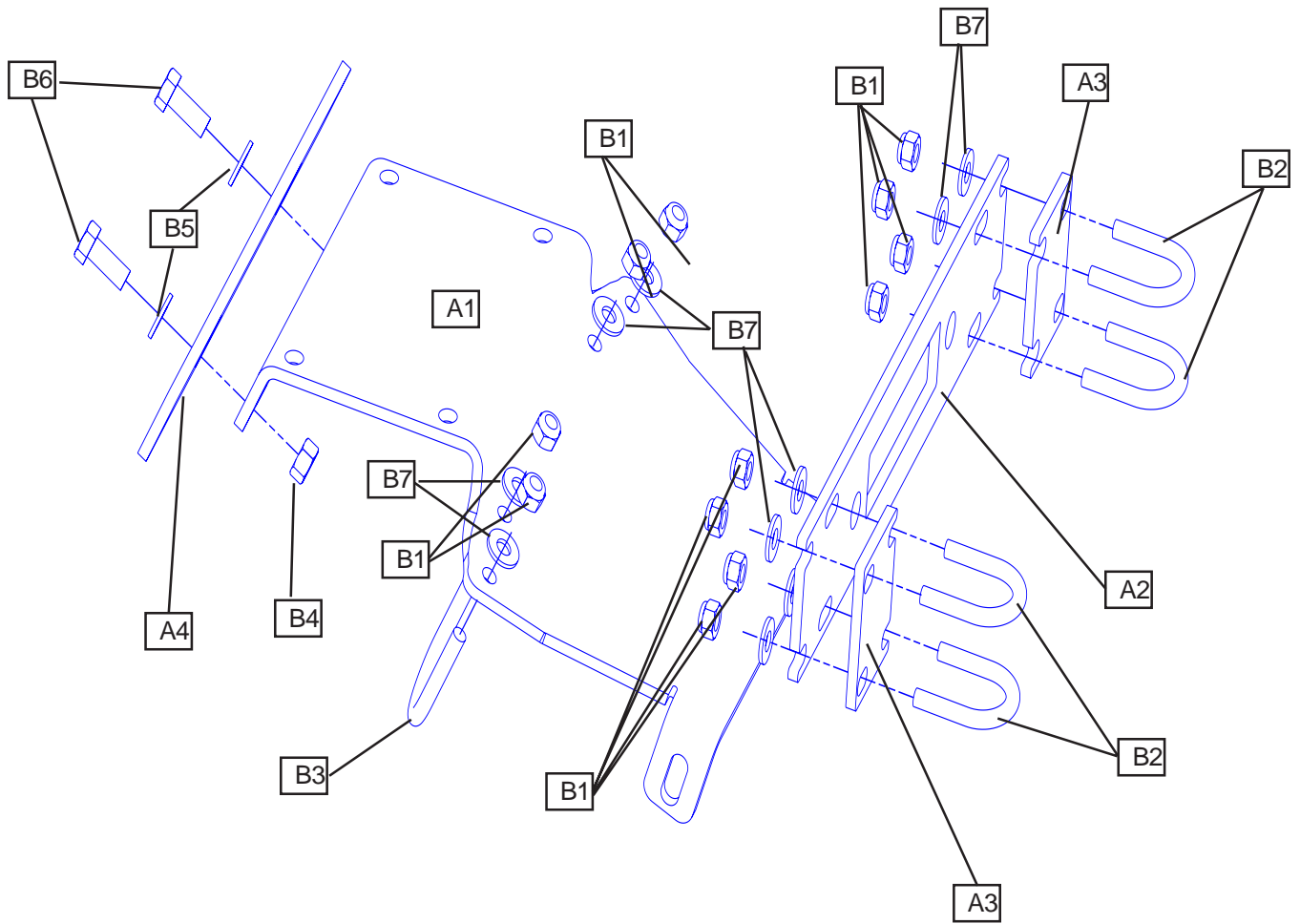

I. Parts List

<u>Ref</u>	<u>Part #</u>	<u>Description</u>	<u>Qty</u>
A1	68283	Mounting Plate	1
A2	68285	Fairlead Brkt Support	1
A2	32629	Fairlead Brkt Support (wide)	1
A3	68286	Fairlead Brkt Spacers	2
A4	68284	Brkt Rear Support	1
B1	6725	1/4-20 Locking Hex Nut	12
B2	21445	U-Bolt 1/4-20 x 1 x 1 1/2	4
B3	65099	U-Bolt 1/4-20 x 1 1/8 x 1 3/4	6
B4	2002	5/16 Locking Hex Nut	2
B5	1324	5/16 Flat Washer	2
B6	3870	5/16-18 x 3/4 Hex Cpsc	2
B7	1320	1/4 Flat Washer	12

II. Tools Required

- Ratchet
- Sockets: 10mm, 12mm, 13mm, 1/2", 7/16"
- Wrenches: 13mm

III. Rancher Installation

1. Begin by removing the front fascia and front skid plate on the vehicle as shown in figure 1. Save the fasteners as they will be used later to re-install the front fascia and skid plate.
2. Remove the 8mm bolts on both sides located inside the front tires and on the ends of two horizontal tubes on the front tube frame as shown in figure 2.
3. Place the mounting plate (A1) inside the front tube frame. The tabs with the slotted holes facing down. The slotted tabs should align where the two 8mm bolts were removed in step 2. Reinstall these two bolts at this time tighten to just finger tight. Install the two 1/4-20 u-bolts (B3) and locking hex nuts (B1) and flat washers (B7) at this time see figure 3, do not tighten down at this time. so the plate can be adjusted for position see figure 2.
4. Place the rear support bracket (A4) into position and attach with the two 5/16-18 x 3/4 hex cap screws (B6), flat washer (B5) and locking nut (B4). Adjust the position of the support bracket so that it comes in contact with the frame tubes and tighten the fasteners see figures 3 and 4. Make sure the support bracket maintains contact with the rear frame tubes and tighten down the two front 8mm mounting bolts. Tighten the bolts to a recommended torque of 12 ft-lb (17 N-m).
5. Attach the fairlead bracket support (A2) to the front frame tubes see figure 5. The support bracket attaches behind the front tubes. Space the bracket away from the tubes using the spacer brackets (A3). Attach the brackets using the 1/4-20 u-bolts (B2), lock nuts (B1) and flat washers (B7). Before tightening the u-bolts make sure the bracket is in the correct position by fitting the front fascia into position and checking location. Tighten the nuts to a recommended torque of 7 ft-lb (10 N-m). **NOTE:** If this kit is being installed on a 00 to 03 Honda the wider fairlead bracket (A2) will need to be used. This will require the use of the wider u-bolts (B3). The spacer brkts (A3) will not be required when installing the wider fairlead brkt.
6. Place the winch into position as shown in figure 6 and figure 7. Attach the winch using 4 5/16-18 x 1 hex head cap screws and 5/16 lock washers. These fasteners will be found in the winch hardware package. Tighten the bolts to a recommended torque of 12 ft-lb (17 N-m).



Figure 1

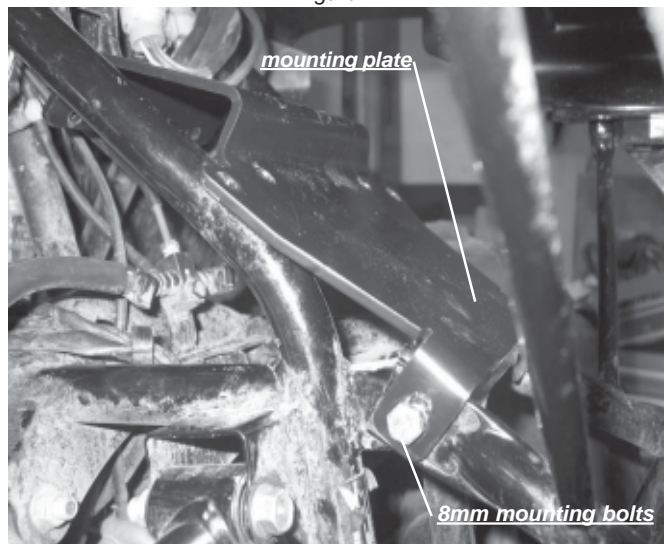

Figure 2

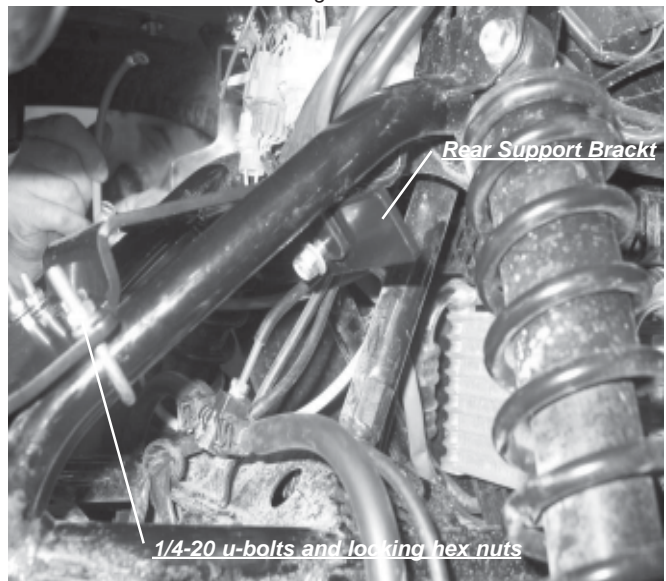

Figure 3

10. Attach either the cast-iron hawse or roller fairlead (depending on your winch kit) to the fairlead support bracket (A2) using 3/8" dia bolts, nuts, and washers provided with the winch as shown in figure 6. Hawse users will need to remove the hawse from the fairlead plate before mounting on the support bracket. Tighten all nuts and bolts securely.
11. Switch the winch clutch to freespool. Manually feed the winch cable through the hawse or roller fairlead. Attach the clevis hook, found with the winch, to the end cable loop. Reengage the winch clutch.
12. Reinstall the front fascia and skid plate using the hardware removed in step 1.
13. Complete the winch installation as described in the winch installation and specification guide that came with the winch.

⚠ WARNING

Tighten all nuts and bolts securely. Failure to check all nuts and bolts prior to use can result in product failure which can lead to vehicle damage and operator injury or death.

14. Figures 8 and 9 show location of a suggested position of the contactor that comes with the winch. This location is on the right side of the ATV mounted to the side of the storage box. Mounting the contactor in this location will require drilling two holes in the side of the storage box.

Winch and winch mount installation is now complete section V, entitled "Maintenance/Care".

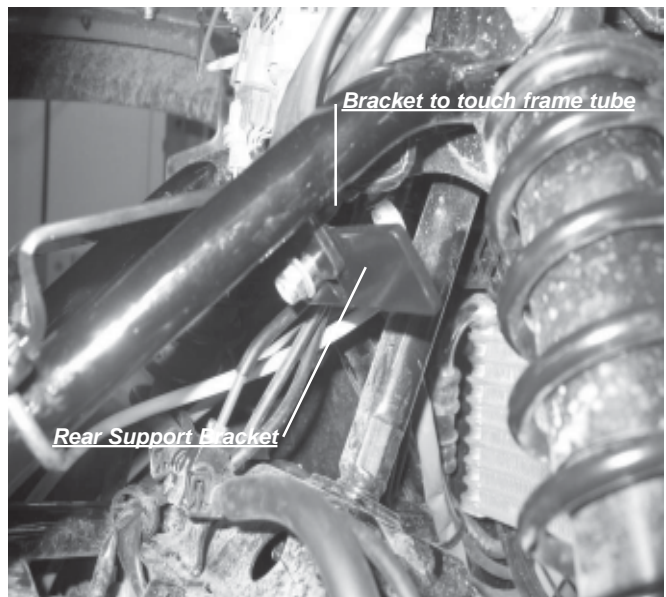

Figure 4

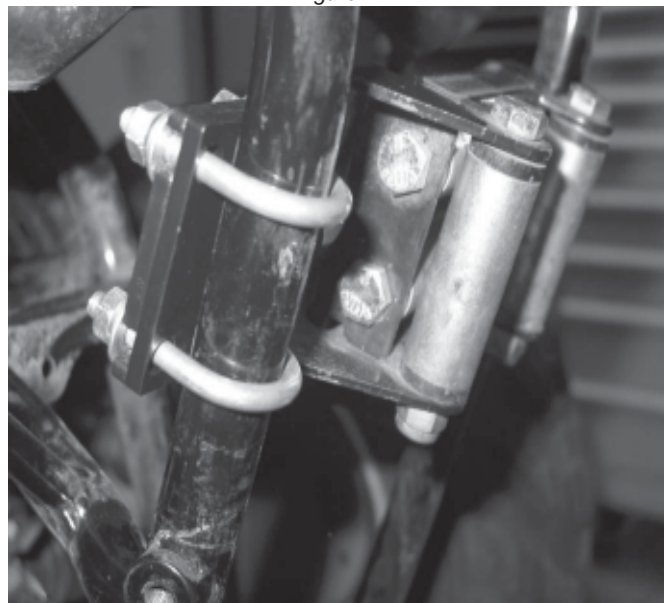

Figure 5

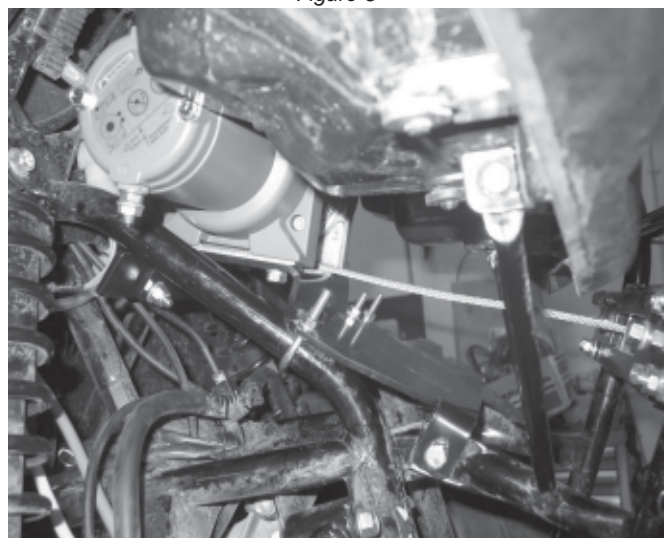

Figure 6

IV. Maintenance/Care

- Inspect all metal parts on the winch, winch mount, and related hardware. Replace all that appears rusted or deformed prior to use.
- Inspect all nuts and bolts on the winch, winch mount, and related hardware prior to each use. Tighten all nuts and bolts that appear to be loose. Stripped, fractured, or bent bolts or nuts need to be replaced

⚠ WARNING

Failure to perform regular inspections and maintenance on the winch, winch mount, and related hardware may result in vehicle damage and operator injury or death.

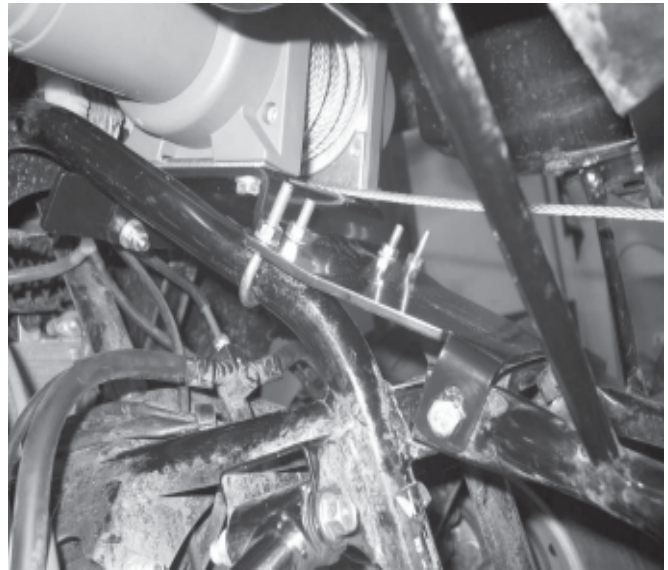

Figure 7

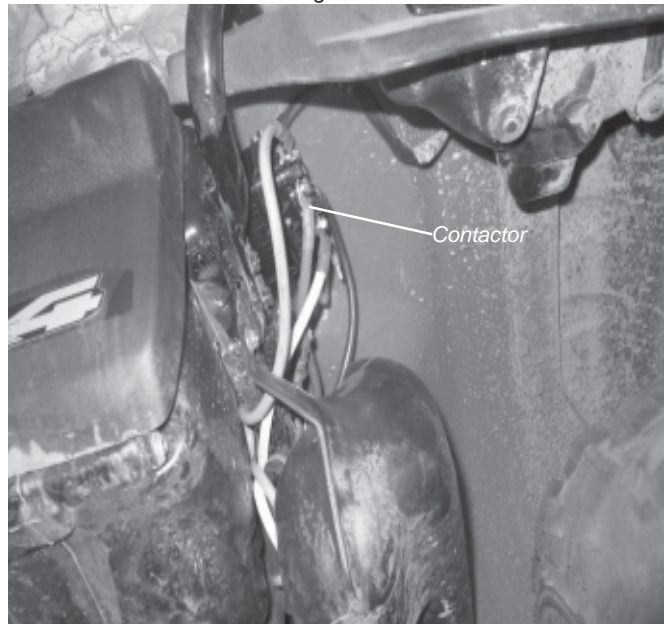

Figure 8

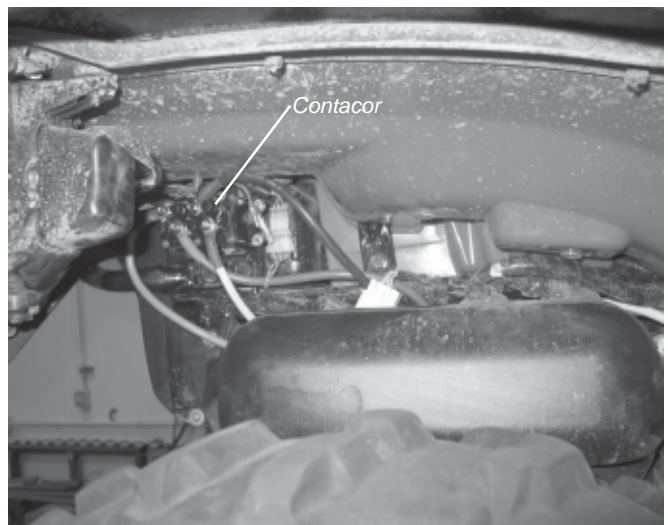

Figure 9